

**rullari®**

**bgc**  
Bolton Gate Company

# **FIREROLL E120**



# rullari®

## STYLISH SECURITY

### Bolton Gate Company

## TWO HOUR FIRE RESISTING ROLLER SHUTTER

Bolton Gate Company offers probably the most comprehensive range of modern fire resisting shutters available on the market today; products which satisfy the needs of large/complex packages as well as meeting the most stringent safety and insurance requirements. All Bolton Gate fire doors and shutters are tested and assessed by officially recognised and competent authorities.

Bolton Gate fire resisting roller shutters are designed for fire protection with durability and reliability in mind. Fireroll E120 is suitable for various installations including department stores, shopping centres, warehouses, factories, and car parks.

The shutter has been tested to EN 1634-1 for fire resistance and is rated E120 in accordance with EN13501, EN13241, EN16034 & EN15269.

Additionally, the shutter has been successfully rated to E60 when fixed to flexible structures in accordance with EN15269-10 Clause J.1.2

The product is CE marked accordingly.

#### STANDARD SPECIFICATION

##### Operation

Suitable for all sizes of shutters, the Speedsafe drive unit has a 230-volt nominal single phase or 400-volt nominal three phase geared induction motor with an electromagnetic brake, limit switches, release unit, a builtin starter panel and low-level push button station with emergency stop button.

The design provides a fail-safe system which will close the shutter automatically in the event of a fire situation.

Activation is via a signal for the fire alarm system to an auto reset solenoid which, when activated, releases the motor brake allowing the shutter to close by gravity with a controlled descent.

A safety brake is supplied to comply with the safeguarding requirements of EN 12604.

Manual operation in the event of a power loss is achieved by releasing a pull cord to close the shutter under controlled descent and a hand chain to open.

##### Curtain

Shutter curtain is constructed from continuously interlocked 76mm curved section steel laths which are securely held in place by end locks. Lath thicknesses vary dependent upon opening size.

##### Bottom Rail

Bottom rails are galvanised, and roll formed into a Tee section.

##### Side Guides

Channel section galvanised mild steel guides with slotted fixings for expansion in a fire are fixed to the jambs with continuous steel angles.

##### Roller

The roller is made from seamless tube of sufficient diameter and wall thickness to resist deflection and is supported in bearings mounted on each endplate.

##### Endplates

Fabricated from steel plate and prepared to accept the coil casing. Securely bolted to steel angles which are drilled for attachment to the structure at the correct centres.

##### Coil Casing

A galvanised steel coil casing is supplied to maintain the fire seal at the head.

##### Finish

Fireroll E120 is supplied with most parts galvanised as standard. Where nongalvanised parts are utilised, these are finished with one coat of primer paint.

##### MAXIMUM SIZES

7000mm wide x 7000mm high as standard 12000mm wide - height dependent (please contact our sales team to discuss)

##### WEIGHT

Varies with opening size dependent on lath/barrel/casing requirements but approximately 50kgs/m<sup>2</sup>.

##### OPTIONS

- Heat/smoke detectors
- Audio visual warning
- Polyester powder coated finish to a range of standard RAL colours.
- Grade 304 or 316 stainless steel.

**KOKEMA<sub>oy</sub>**

Kakkulaistentie 5, 32800 Kokemäki

Tel. +358 10 326 3840

[info@kokema.fi](mailto:info@kokema.fi) | [www.kokema.fi](http://www.kokema.fi)

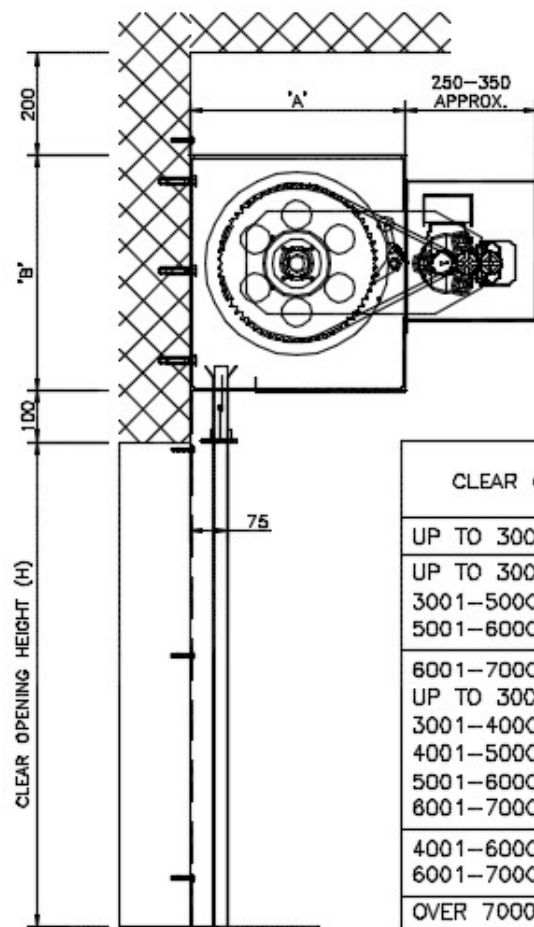

SECTION VIEW

CLEAR OPENING WIDTH (W) x HEIGHT (H)	MAXIMUM BOX SIZES	
	'A'	'B'
UP TO 3000 WIDE x UP TO 1500 HIGH	260	290
UP TO 3000 WIDE x 1501-3000 HIGH 3001-5000 WIDE x UP TO 2500 HIGH 5001-6000 WIDE x UP TO 2000 HIGH	330	360
6001-7000 WIDE x UP TO 2700 HIGH UP TO 3000 WIDE x 3001-7000 HIGH 3001-4000 WIDE x 2501-7000 HIGH 4001-5000 WIDE x 2501-5000 HIGH 5001-6000 WIDE x 2001-5000 HIGH 6001-7000 WIDE x 2701-4200 HIGH	420	460
4001-6000 WIDE x 5001-7000 HIGH 6001-7000 WIDE x 4201-7000 HIGH	475	530
OVER 7000 WIDE x OVER 7000 HIGH	AVAILABLE ON REQUEST	

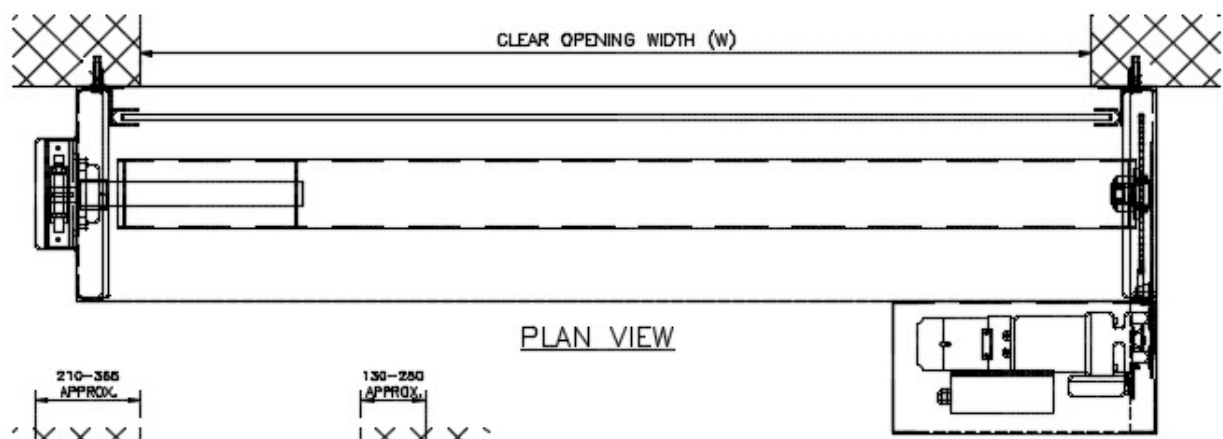

PLAN VIEW

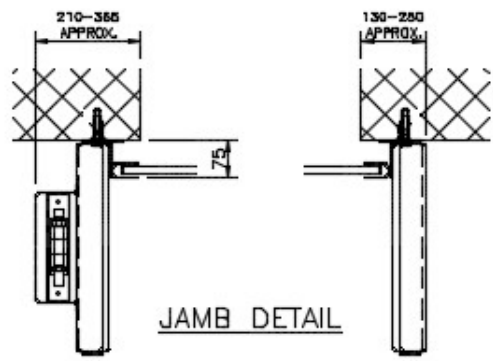

JAMB DETAIL

ALL DIMENSIONS IN MM



